

# Technical Enquiry Form

## DTS Telescopic Connectors

### Beam connection loads up to 150 kN ULS

Please provide below the contact information, project details, dimensions and load data.

#### Product Range

Telescopic Beam  
Connectors

#### Product Options

DTS 150

#### Layout Option

Beam with rectangular  
cross section

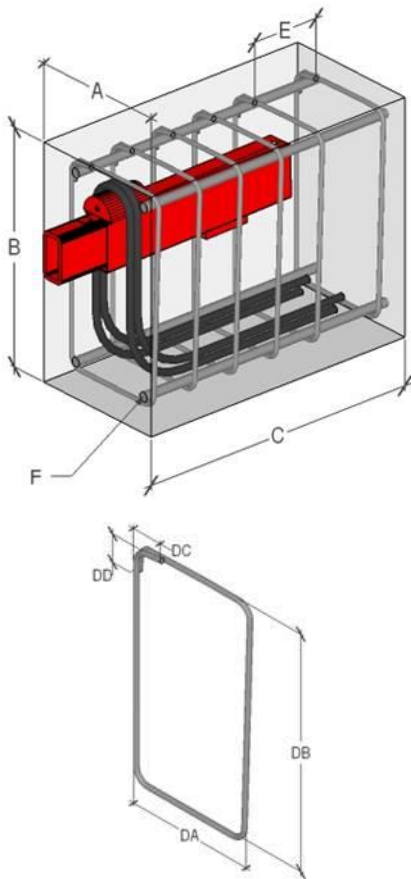

For alternative loadings, go to  
[invisibleconnections.co.uk](http://invisibleconnections.co.uk)  
or call us for advice

**Invisible Connections Ltd**  
Unit 6, Thame Forty  
Jane Morbey Road  
Thame, Oxfordshire OX9 3RR  
**+44 (0)1844 266000**  
[sales@invisibleconnections.co.uk](mailto:sales@invisibleconnections.co.uk)  
[invisibleconnections.co.uk](http://invisibleconnections.co.uk)

#### Contact and project details

Contact name .....

Company .....

Telephone .....

Email .....

Project name .....

Project location .....

Main contractor.....

Precaster .....

Precast element reference .....

Drawing number(s) .....

Casting start date (estimate) .....

Casting end date (estimate) .....

#### Dimensions

See A-F on image to left. Please enter dimensions in mm.

A Beam width .....

B Beam height .....

C Beam length .....

D Link shape (51) (Dia. ....mm)  
(DA .....mm) (DB .....mm) (DC .....mm) (DD.....mm)

E Link centres .....

F Bar dia. ....

#### Load data

(Example)

Total load through connection ..... (140 kN)

Using the above information we will conduct an initial assessment of the application and advise suitable product selection, supported by calculations as required.

Please email completed enquiry form and any supporting drawings to [technical@invisibleconnections.co.uk](mailto:technical@invisibleconnections.co.uk)

For technical and practical advice call **+44 (0)1844 266000**